

101 CALIFORNIA STREET

San Francisco, California

PHILIP JOHNSON • ALAN RITCHIE
ARCHITECTS



Located in downtown San Francisco, the site consists of a 48 storey cylindrical tower, 7 storey triangular building base, entrance atrium, and a public plaza. Zoning requirements were met with the saw-toothed recesses that step up three times to reach the 600 foot height of the tower. The volume of the tower is cut away at the intersection of the tower and base, revealing the structural columns which pierce through the volume of the angular, all-glass 88 foot-high lobby. The positioning and massing of the building creates a hinge point for intersecting street grids.

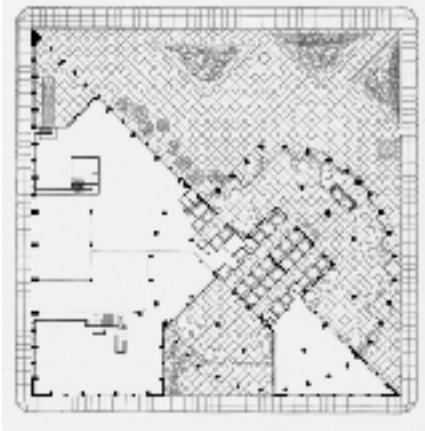

Completion Date: 1982

Associate Architect: KWA Inc. Architects