

CATHEDRAL OF HOPE

Dallas, Texas

"We want you to walk in that front door and be knocked dead...you will have tears in your eyes within five minutes of walking in."

Philip Johnson

PHILIP JOHNSON • ALAN RITCHIE
A R C H I T E C T S

The Dallas branch of the Universal Fellowship of Metropolitan Community Churches, the nation's largest gay and lesbian religious denomination, commissioned the design for the cathedral in 1995 and are in the process of raising the funds now needed to build it.

In its rough model form, the Cathedral of Hope rises, like an iceberg emerging from the sea, and soars to a crowning peak over the altar. The finished version of the cathedral will be approximately 282 feet in length with 159 feet of an adjacent arcade area -- taller than Notre Dame in Paris. The 27 year-old congregation, has already outgrown its present 900-seat building which it moved into in 1993. The new cathedral will seat 2,200 and aspires to the feeling of the great Gothic cathedrals.

The design stems from the firm's exploration of a new architectural direction, one where conventional geometry is rejected in favor of a more expressive and free form.

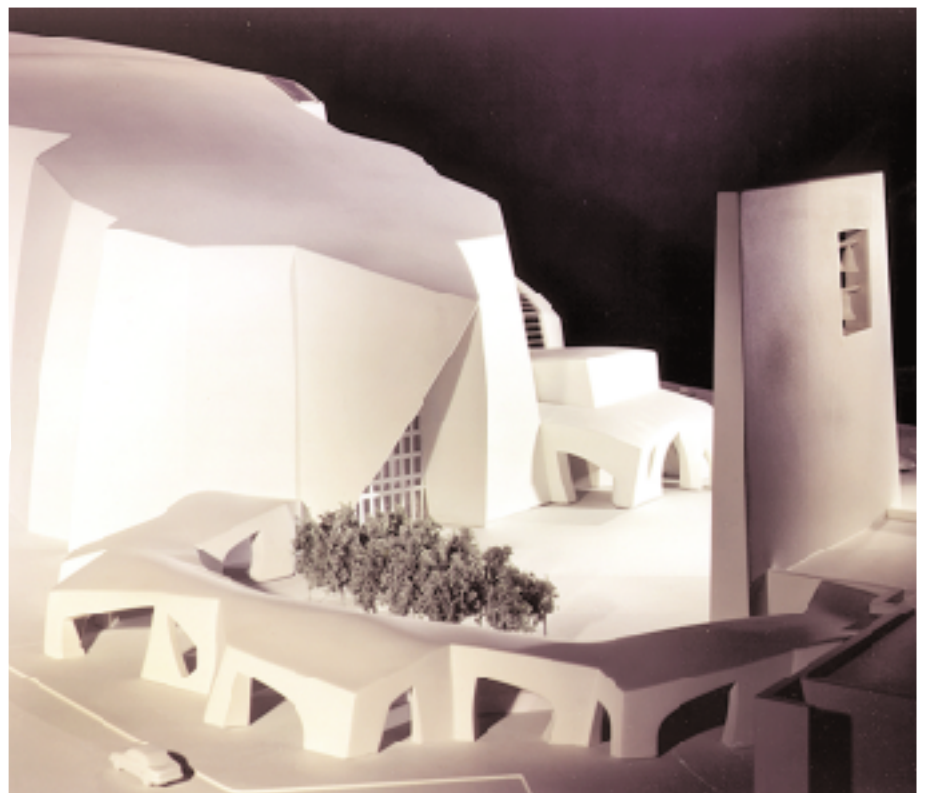
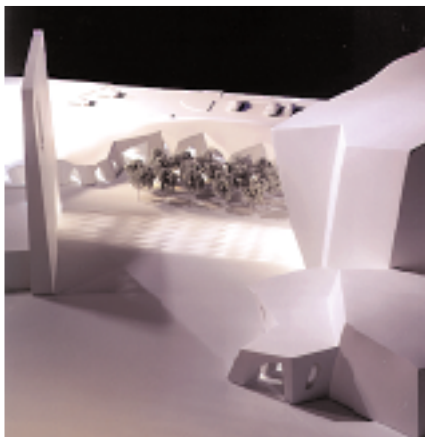
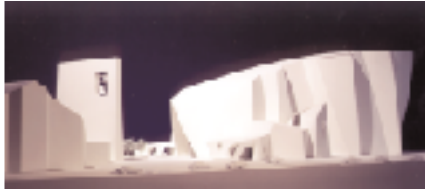

Client: The Universal Fellowship of
Metropolitan Community Churches

Area: 40,000 ft.2