

# PPG CORPORATE HEADQUARTERS

Pittsburgh, Pennsylvania

**PHILIP JOHNSON • ALAN RITCHIE**  
A R C H I T E C T S



This complex is the headquarters of PPG Corporation. Formerly, the company's offices had been scattered throughout various buildings in downtown Pittsburgh. When the company decided to relocate to an urban renewal district, and therefore required a complex with a strong corporate identity that could also create an urban center, they came to Philip Johnson.

The aim of creating a neighborhood led the architects to plan two public squares on the five-block site. These public spaces were designed to complement the existing public spaces nearby. An enclosed winter garden brings adjacent park land inside. In the center of the complex are six office buildings—one of forty stories, one of thirteen, and five of five. They surround a plaza of paved granite, a pedestrian space which complements but does not repeat, the design of the nearby Market Square, a traditional town green. The design of the facades was inspired by an insight into the nature of reflective glass, one of the corporation's core products. Highly reflective glass, an opaque material, is perhaps more similar to stone than to traditional glass. The building's many articulations, bays and buttresses create interest similar to the shadows and highlights of a stone building.

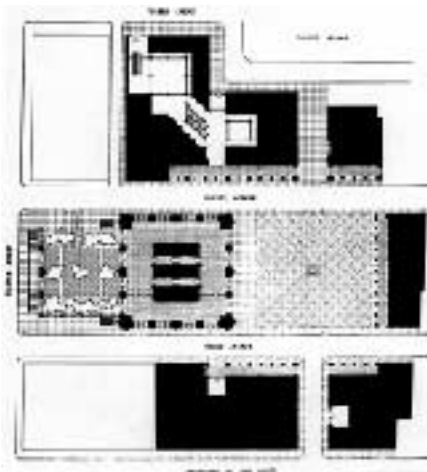

Client: PPG Industries  
Completion Date: 1985  
Area: 2,000,000 square feet