

SETON HILL COLLEGE

Ryan Fine Arts Center
Greensburg, Pennsylvania

PHILIP JOHNSON • ALAN RITCHIE
ARCHITECTS

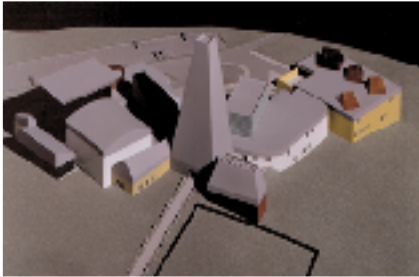

This project is a new fine arts facility for a small, private liberal arts college in Greensburg, Pennsylvania. The major functions are a 600 seat theater, a 180 seat flexible theater, ancillary production areas, performance spaces, art studios, classrooms, offices, an art gallery and an entrance pavilion.

Located on the top of a hill, 100 yards from the nearest school building, the grouping of component structures is reminiscent of an Italian hill town with a 150 foot tall entrance tower acting as the campanile. The facility is organized around the entrance tower, with the theater wing off to one side, the art gallery to another and studios and classrooms in a third direction.

All fascias and sloping roofs are covered in lead coated copper with the remainder of the skins clad in a variety of rich, double-red glazed brick. Colors are red, black, yellow, green, grey, and blue. All metalwork is white.



Client: Seton Hill College
Area: 100,000 square feet

